

# PLAN SAL W HOTELE GOŁĘBIEWSKI

---

# PLAN SAL W HOTELU GOŁĘBIEWSKI

## PARTER

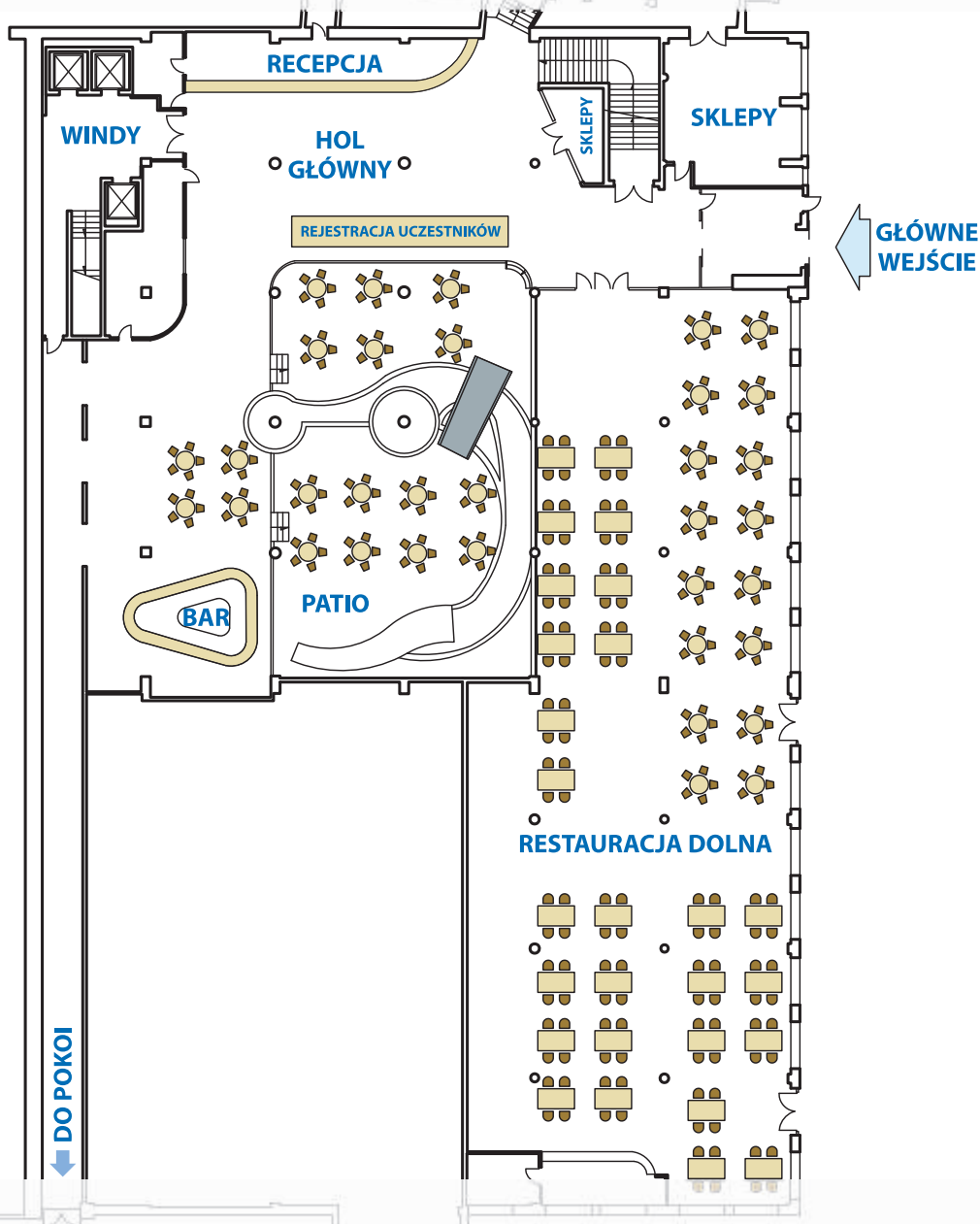

# PIĘTRO I

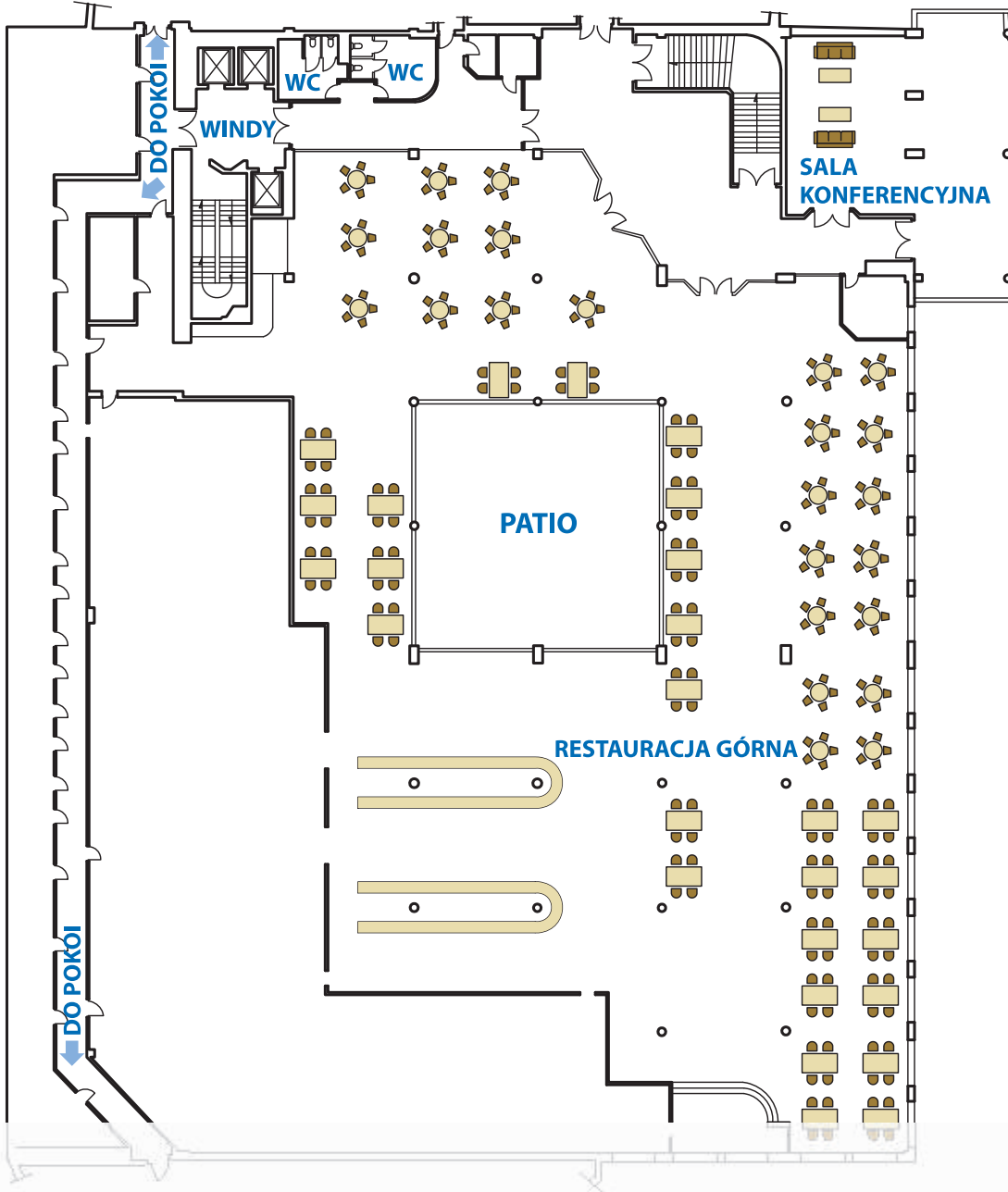

# PIĘTRO III

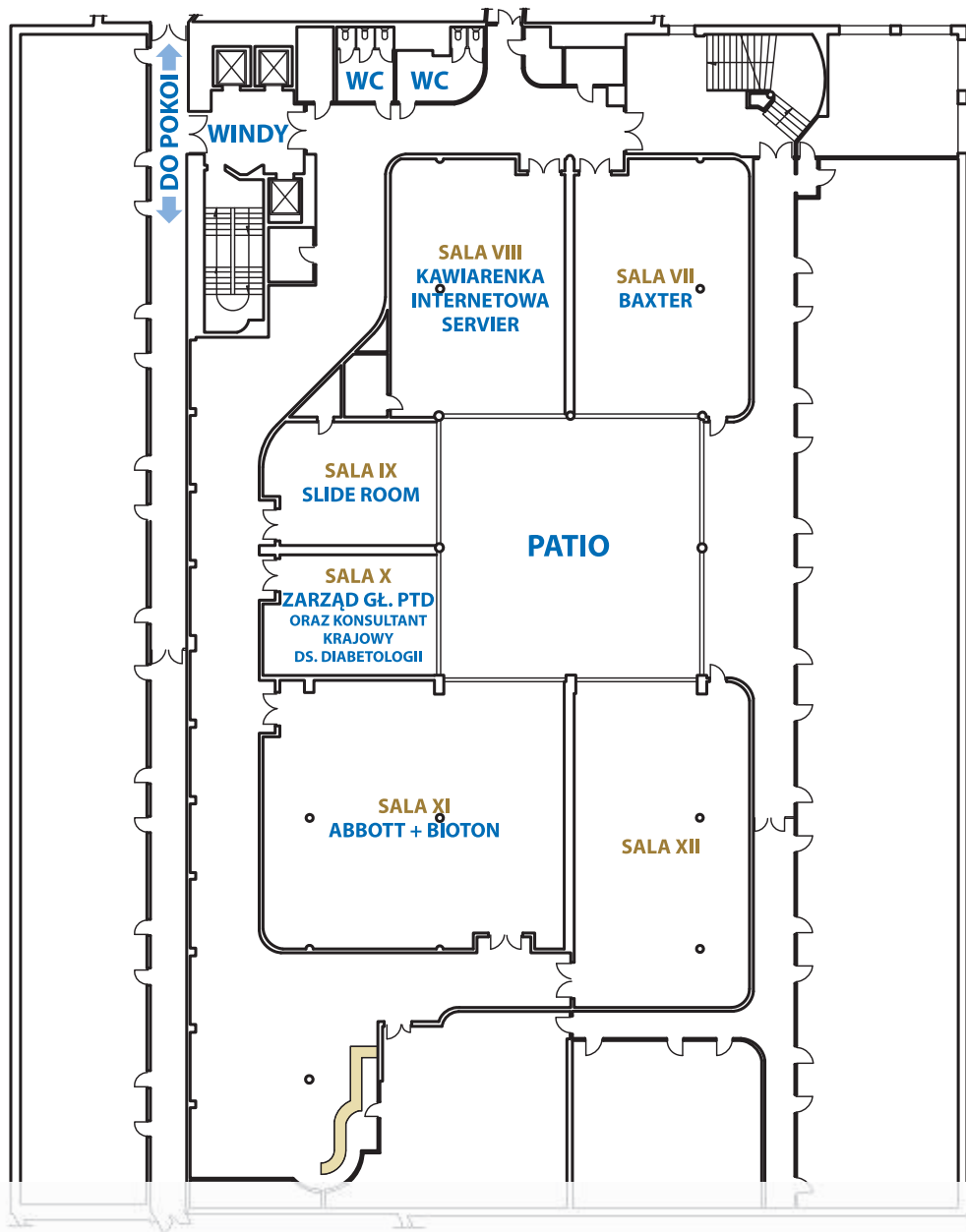

# PIĘTRO IV

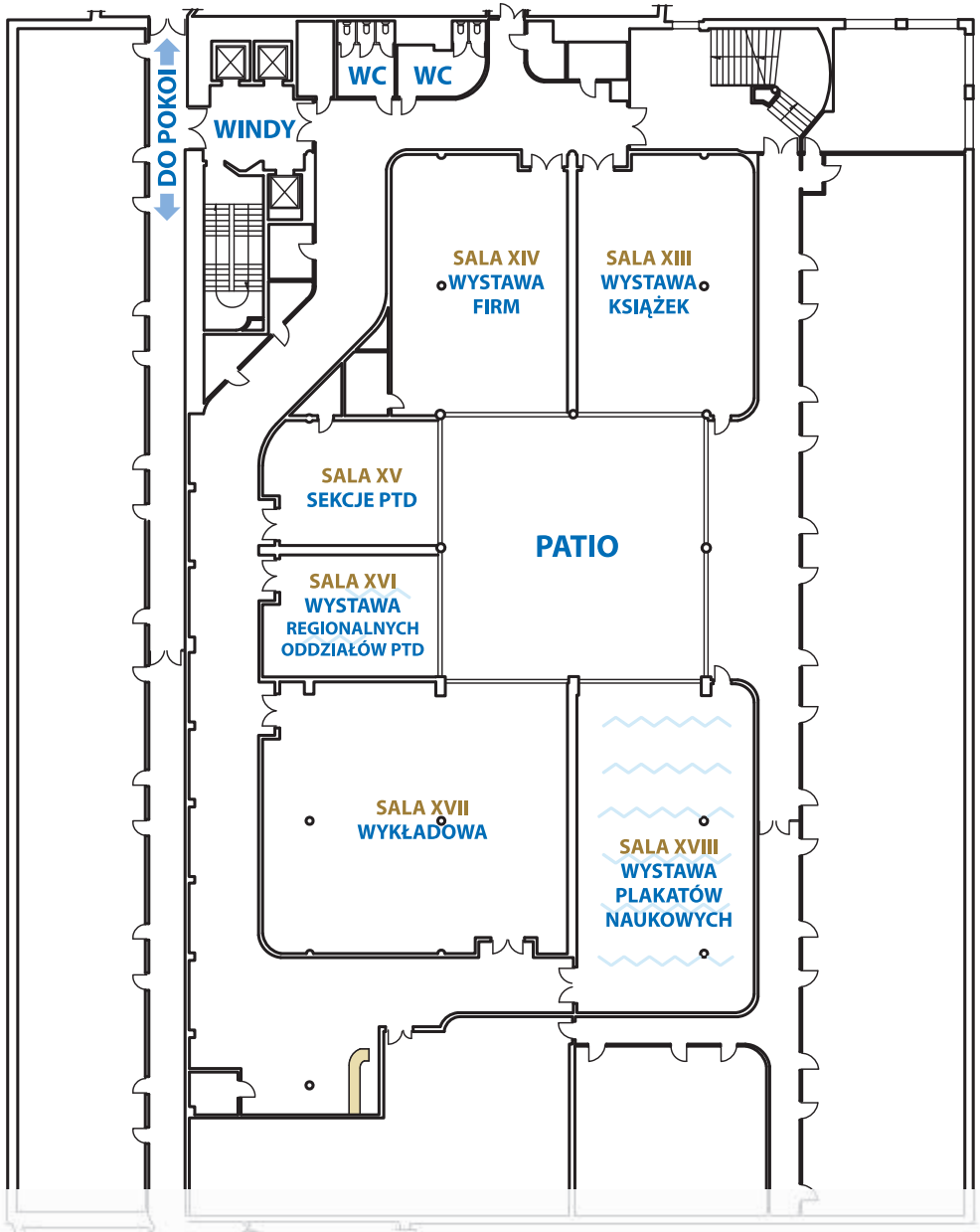

# PIĘTRO V

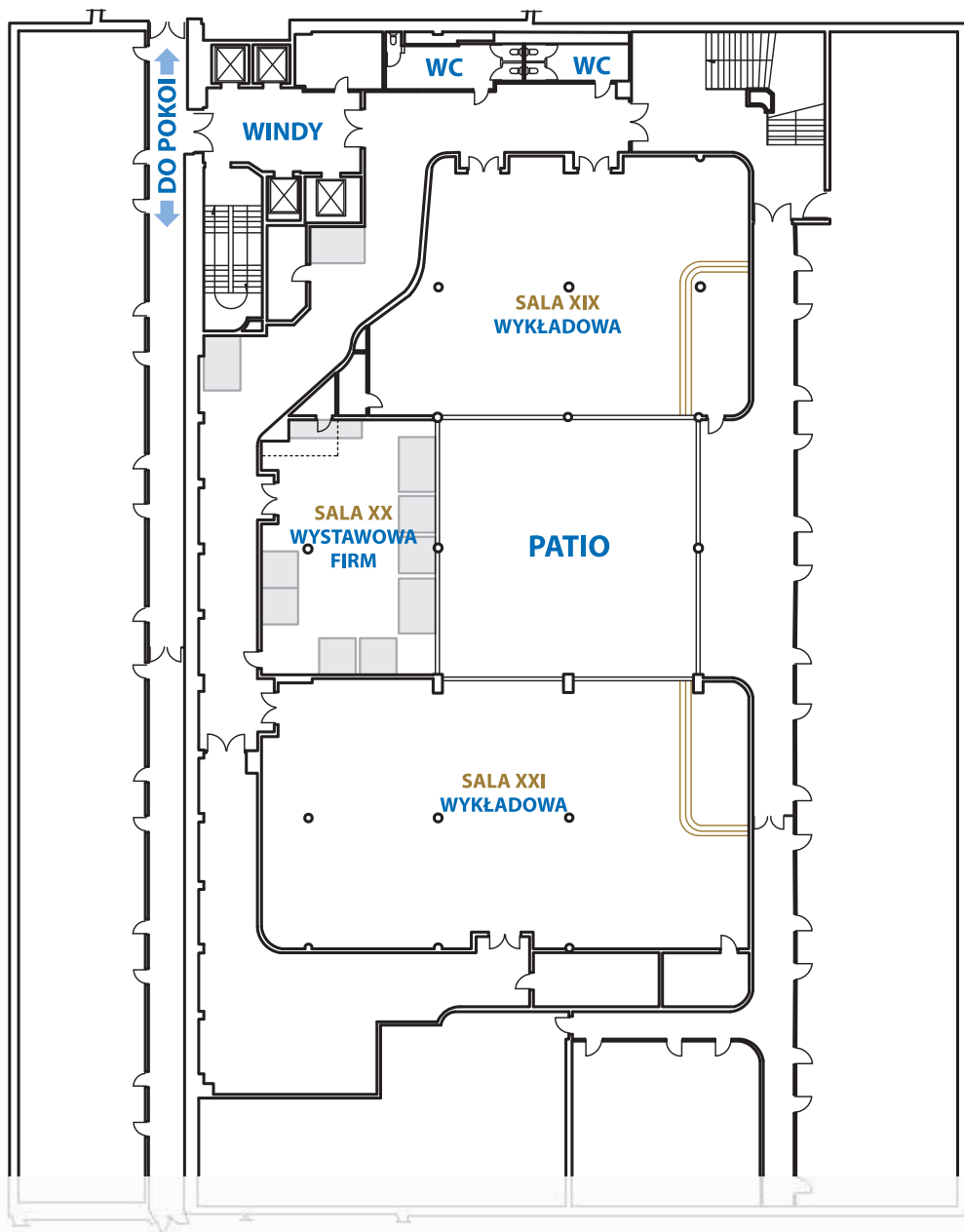

# PIĘTRO VI

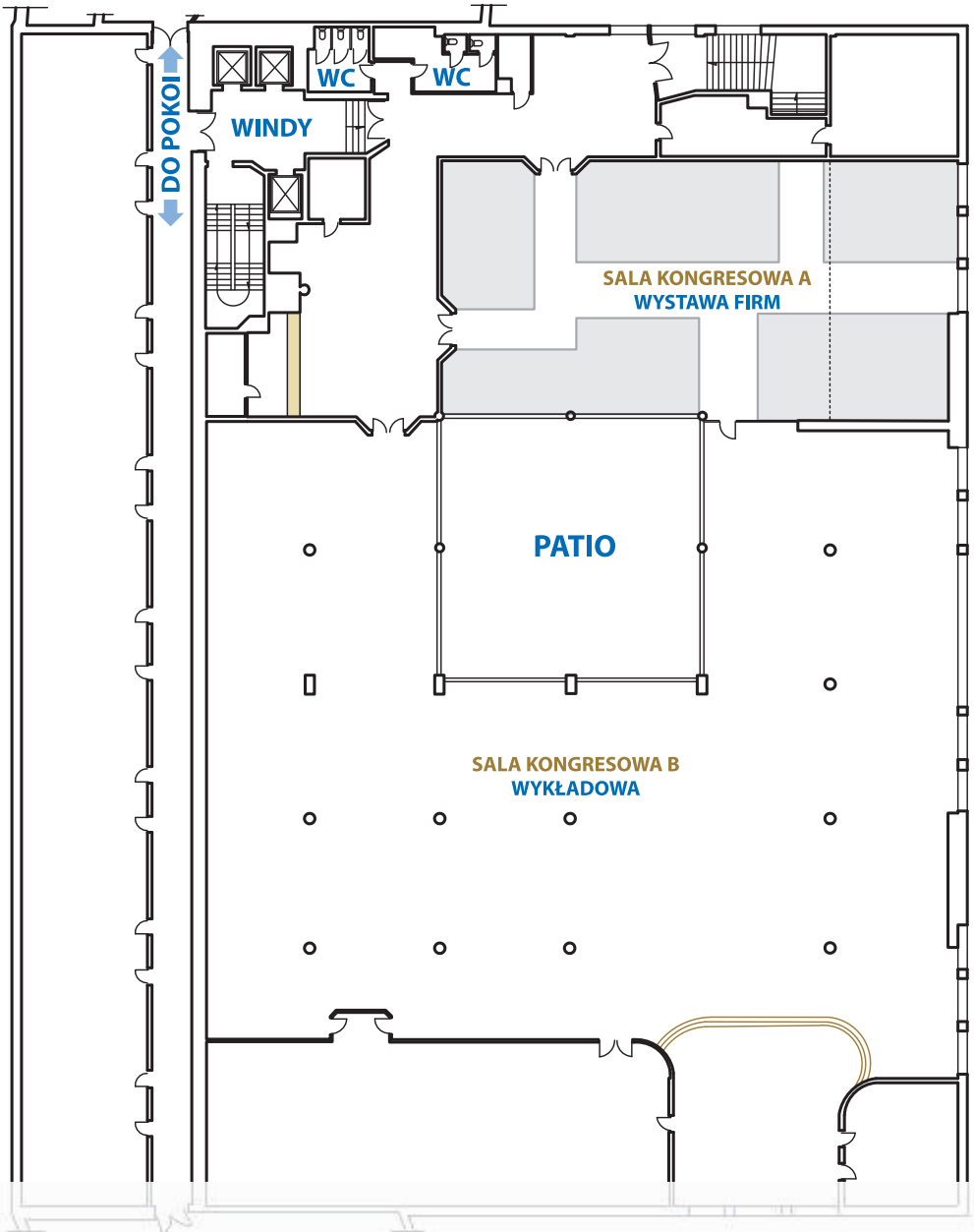

# PIĘTRO VIII

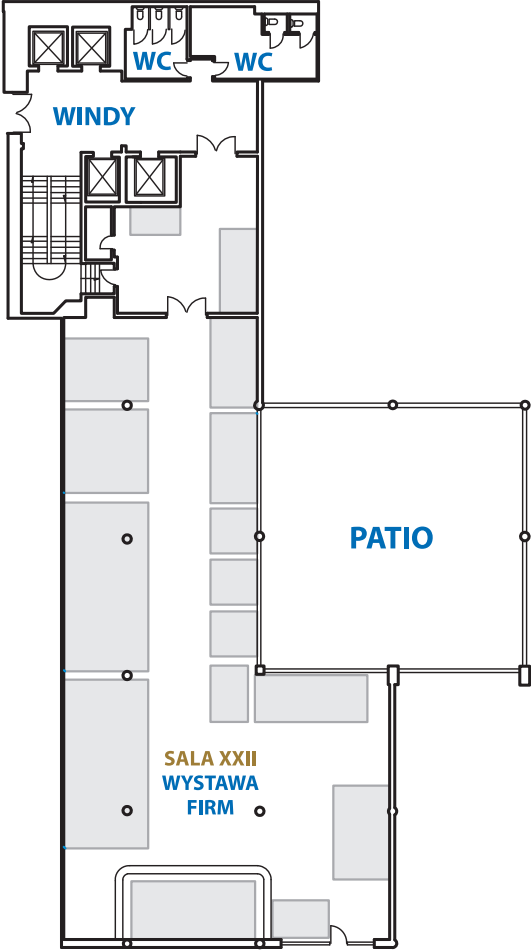



# WYSTAWY FIRM PIĘTRO V

- 01 - Medycyna Praktyczna
- 02 - Akme
- 03 - Diabetologia na co dzień
- 04 - Terapia
- 05 - Lekarz
- 06 - Medical Tribune
- 07 - Polska Federacja Edukacji w Diabetologii
- 08 - Diabetologia Polska
- 09 - Ital-Net
- 10 - Via Medica
- 11 - Art Table

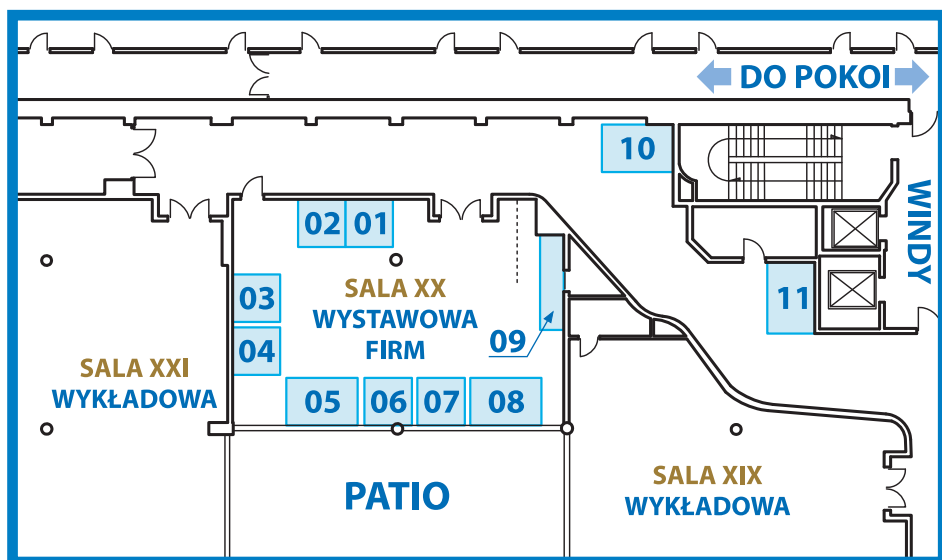

# WYSTAWY FIRM PIĘTRO VI

12 - Sanofi Aventis

13 - Servier

14 - Polpharma

15 - Abbott + Bioton

16 - Novo Nordisk

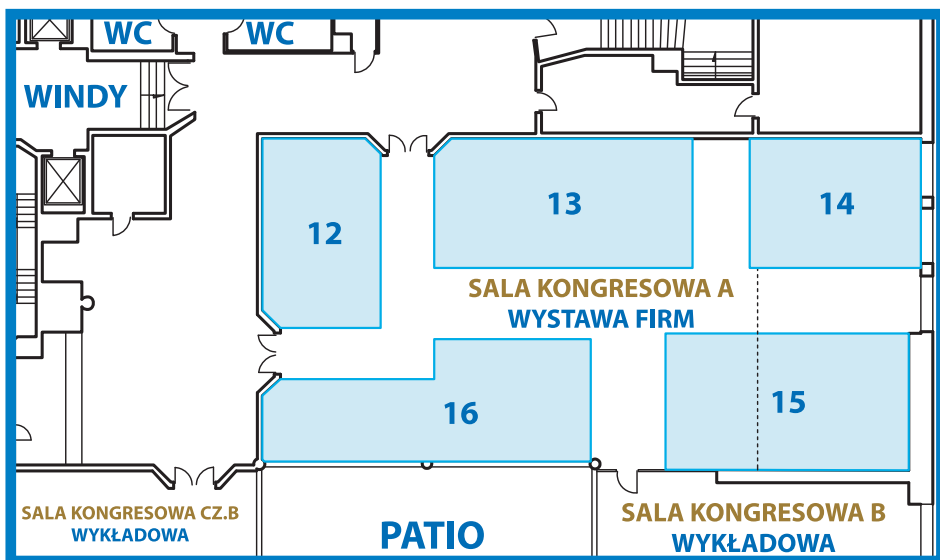

# WYSTAWY FIRM PIĘTRO VIII

- 17 - Johnson & Johnson
- 18 - Polfa Tarchomin
- 19 - Roche Diagnostic
- 20 - Symphar
- 21 - Glaxo Smith Kline
- 22 - Medtronic
- 23 - Wielka Orkiestra Świątecznej Pomocy
- 24 - Solvay Pharma
- 25 - Zentiva
- 26 - Woerwag Pharma
- 27 - Eli Lilly
- 28 - Bayer HealthCare
- 29 - Merck
- 30 - Pfizer
- 31 - Abbott
- 32 - Raisio Polska Foods

